

## 2D BLOW-UP LAYOUT | SUITE 380

O2 CORPORATE OFFICE FURNITURE | GRADE 2 | THIN BASE | POWERED

### SCOPE:

#### OPEN AREA #1

(1) 5'-6"X7'-6"X53"H POWERED WORKSTATION W/  
(1) BOX BOX FILE PEDESTAL (1) 30"W LATERAL FILE & (1)  
DUAL MONITOR ARM

#### OPEN AREA #2

(1) 6'X7'-6"X53"H POWERED WORKSTATION W/  
(1) BOX BOX FILE PEDESTAL (1) 30"W LATERAL FILE & (1)  
DUAL MONITOR ARM  
(1) 6'X7'-6"X53"H PRINT AREA W/ (2) 36"W 2 DRAWER  
LATERAL FILE  
(2) 42"W 3 DRAWER LATERAL FILE (1) 36"W 3 DRAWER  
LATERAL FILE (1) 30"W 3 DRAWER LATERAL FILE

#### OPEN AREA #3

(2) 7'-6"X6'X53"H POWERED WORKSTATIONS  
ACCESSORIES:  
(1) BOX BOX FILE PEDESTAL (1) 30"W LATERAL FILE/EA &  
(1) DUAL MONITOR ARM /EA

#### PRIVATE OFFICES #6, #7 & #8

(1) PRIVATE OFFICE WITH U-SHAPE DESK, OVERHEAD  
STORAGE & MEETING TABLE  
(2) PRIVATE OFFICES WITH U-SHAPE DESK

#### SEATING

(4) YURA STYLISH TASK CHAIRS FOR WORKSTATIONS  
(2) ELLI MESH TASK CHAIRS FOR PRIVATE OFFICES #6 & #7  
(1) VION CHAIR FOR PRIVATE OFFICE #8  
(4) SIDERO GUEST CHAIRS FOR OFFICES #6 & #7  
(4) VION GUEST CHAIRS FOR OFFICE #8

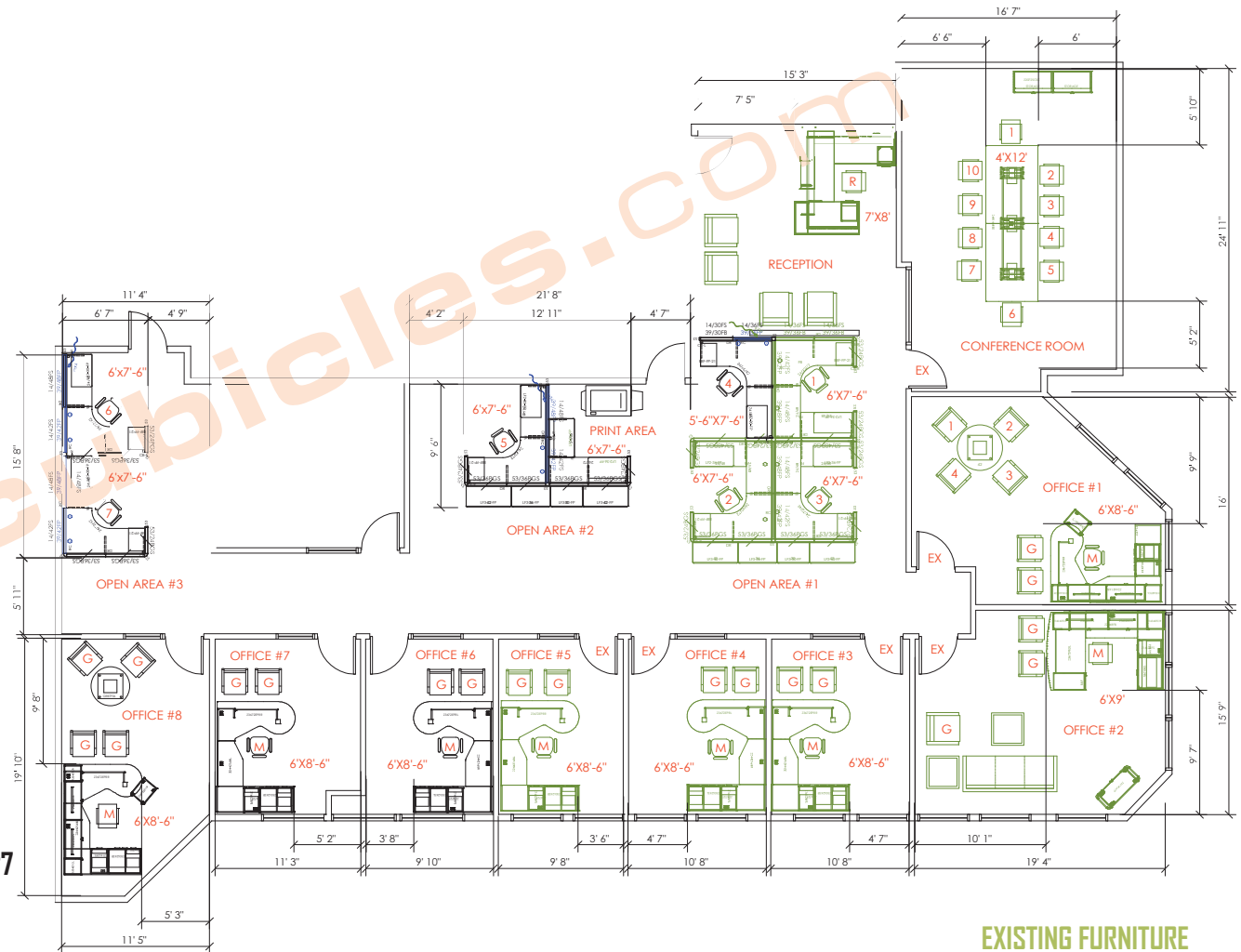

EXISTING FURNITURE  
NEW FURNITURE  
ELECTRICAL